

On your Mac, go to the App Store and search for **Microsoft Remote Desktop** and install **Microsoft Remote Desktop 10** (other versions will not work)

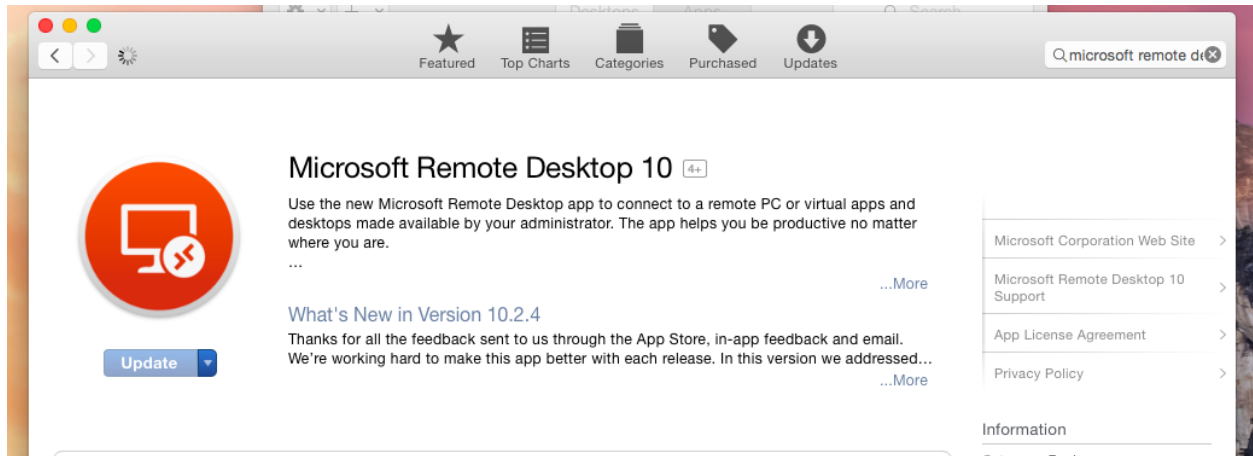

Once installed, go ahead and launch the program. Click on the Plus sign on the top left and click on *Desktop*

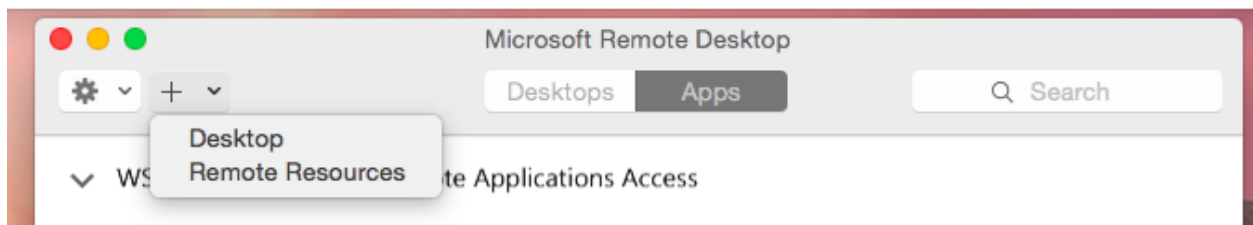

In the PC Name field type **rdsemr.med.wayne.edu** then click on the blue arrow across from *User Account* and click on "Add User Account"

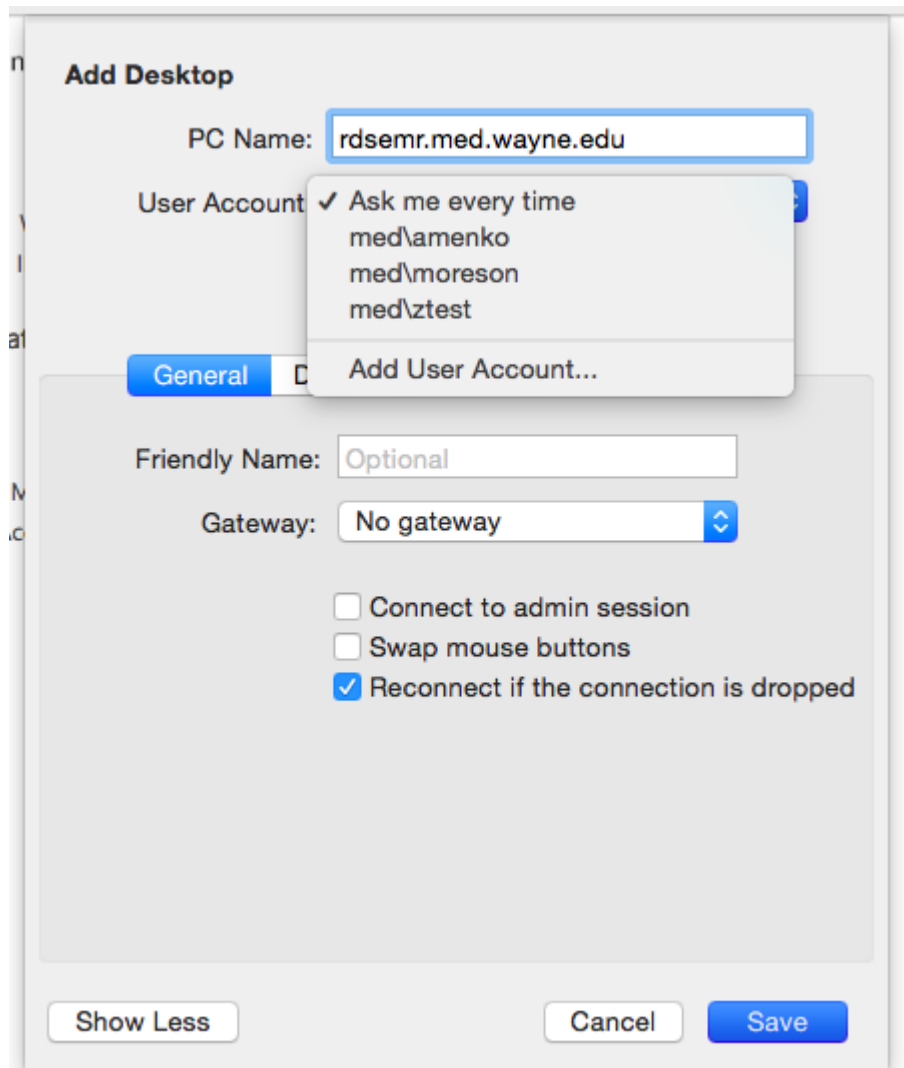

In the *User Name* field put **med** and your MED ID (the ID you use to log onto our computers such as "asmith") then in the *Password* field input the associated password & click Save.

Add User Account

User Name: med\username

Password: Optional

Friendly Name: Optional

Cancel Save

This will take us back to the *Add Desktop* window. Go down and click on the blue arrow across from *Add Gateway* and select **Add Gateway** again. In the *Add Gateway* window you will input **rdsgw.med.wayne.edu** for the *Server Name*. Then across from *User Account* click on the blue arrow and select your MED ID from the dropdown and click *Save*.

Add Gateway

Server Name: rdsgw.med.wayne.edu

User Account: med\moreson

Friendly Name: Friendly name

Cancel Save

This will once again take us back to the *Add Desktop* window. Make sure "Reconnect if the connection is dropped" option is checked, then go ahead and click *Save* one last time.

Add Desktop

PC Name:

User Account:

General | Display | Sound | Local Resources

Friendly Name:

Gateway:

Connect to admin session

Swap mouse buttons

Reconnect if the connection is dropped

This will take us back to the main Microsoft Remote Desktop window. You will see your connection there under the *Desktop* tab. Double click on your connection and it will launch EMR.

